

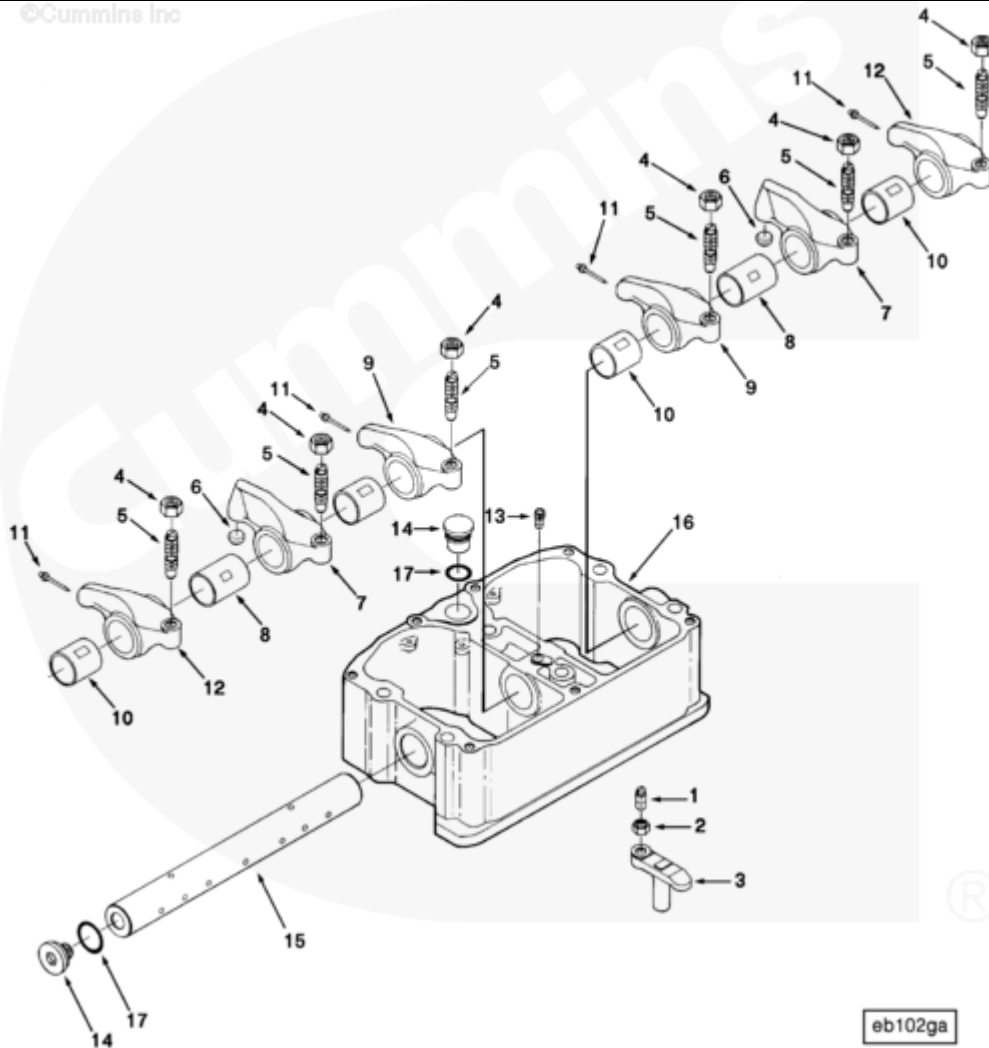

## Parts Catalog - Option Detail

Electronic Parts Catalog - Option Detail				
Option	Group	Graphic	Film Card	Date
EB1004	03.01	eb102ga	F	15-JAN-93
<b>Engines</b>	NH/NT 855, NT495, NT743, NTA855 N106			



[SMALL](#) | [MEDIUM](#) | [LARGE](#)

Cart	Ref No	Part Number	Part Description	Required	Remarks
View My Cart					
		<a href="#">EB1004</a>	Rocker Lever And Housing		
					Rocker Lever And Housing
					Rocker housing with provision

					for accepting an engine
					brake.
<input type="checkbox"/>		3030038	Valve Crosshead		
<input type="checkbox"/>	1	147389	Crosshead Adjusting Screw	1	3/8 - 24 x 3/4 inch
<input type="checkbox"/>	2	203131	Heavy Hexagon Nut	1	3/8 - 24 UNF
	3	3028293	Valve Crosshead	1	
<input type="checkbox"/>		3044788	Housing Rocker	3	Recon equivalent 3044788 RX
<input type="checkbox"/>		AR 2308	Rocker Lever	2	
<input type="checkbox"/>	4	S 212	Regular Hexagon Nut	1	1/2 - 20 UNF
<input type="checkbox"/>	5	168306	Slotted Set Screw	1	
<input type="checkbox"/>	6	194037	Rocker Lever Socket	1	
<input type="checkbox"/>	7	218152	Rocker Lever	2	
<input type="checkbox"/>	8	218153	Bushing	1	
<input type="checkbox"/>		BM95161	Rocker Lever	2	
<input type="checkbox"/>	4	S 212	Regular Hexagon Nut	1	1/2 - 20 UNF
<input type="checkbox"/>	5	168306	Slotted Set Screw	1	
	9	3017571	Rocker Lever	1	
<input type="checkbox"/>	10	140330	Bushing	1	
<input type="checkbox"/>	11	208084	Rivet	1	
<input type="checkbox"/>		BM95162	Rocker Lever	2	
<input type="checkbox"/>	4	S 212	Regular Hexagon Nut	1	
<input type="checkbox"/>	5	168306	Slotted Set Screw	1	
<input type="checkbox"/>	10	140330	Bushing	1	
<input type="checkbox"/>	11	208084	Rivet	1	
	12	3017572	Rocker Lever	1	
<input type="checkbox"/>	13	168319	Socket Set Screw	3	
<input type="checkbox"/>	14	3038903	Rocker Lever Shaft Plug	2	
<input type="checkbox"/>	15	3038904	Rocker Lever Shaft	3	
<input type="checkbox"/>	16	3044787	Rocker Lever Housing	1	

	17	<a href="#">3058653</a>	O-Ring Seal	6	
--	----	-------------------------	-------------	---	--

© 2019 Cummins Inc., Box 3005, Columbus, IN 47202-3005 U.S.A.  
Terms of Use and Disclaimers | Recommended System Requirements  
Need Assistance? Please click on the Contact Us button in the top right corner of any page.